



*The Smart Spot*

# City Avenue Special Services District

## Lighting Program

November 5, 2008

# Program Goals

- ◉ Public Safety
- ◉ Traffic Calming
- ◉ Aesthetics

*The Smart Spot*

CityAve

# Program Steps

- Schematic Plan - Complete
- Engineering & Design - Complete
  - Bid Documents
    - CHE Approval
    - PECO
- Demonstration Project - Complete
  - 54<sup>th</sup> Street
- Funding
- Acquisition & Construction

*The Smart Spot*

CityAve

# Schematic Plan

- ◉ Urban Engineers
- ◉ Plan is Complete
  - City Avenue from Monument to Wynnewood Road
  - 63<sup>rd</sup> Street to Overbrook Avenue/Sherwood Road
  - Bala Avenue
  - 54<sup>th</sup> Street from City to Overbrook
- ◉ Monument to I-76 not possible
  - Target & other property owners
- ◉ Approvals
  - Lower Merion Township
  - City of Philadelphia

*The Smart Spot*

CityAve

# Schematic Plan – Existing Layout

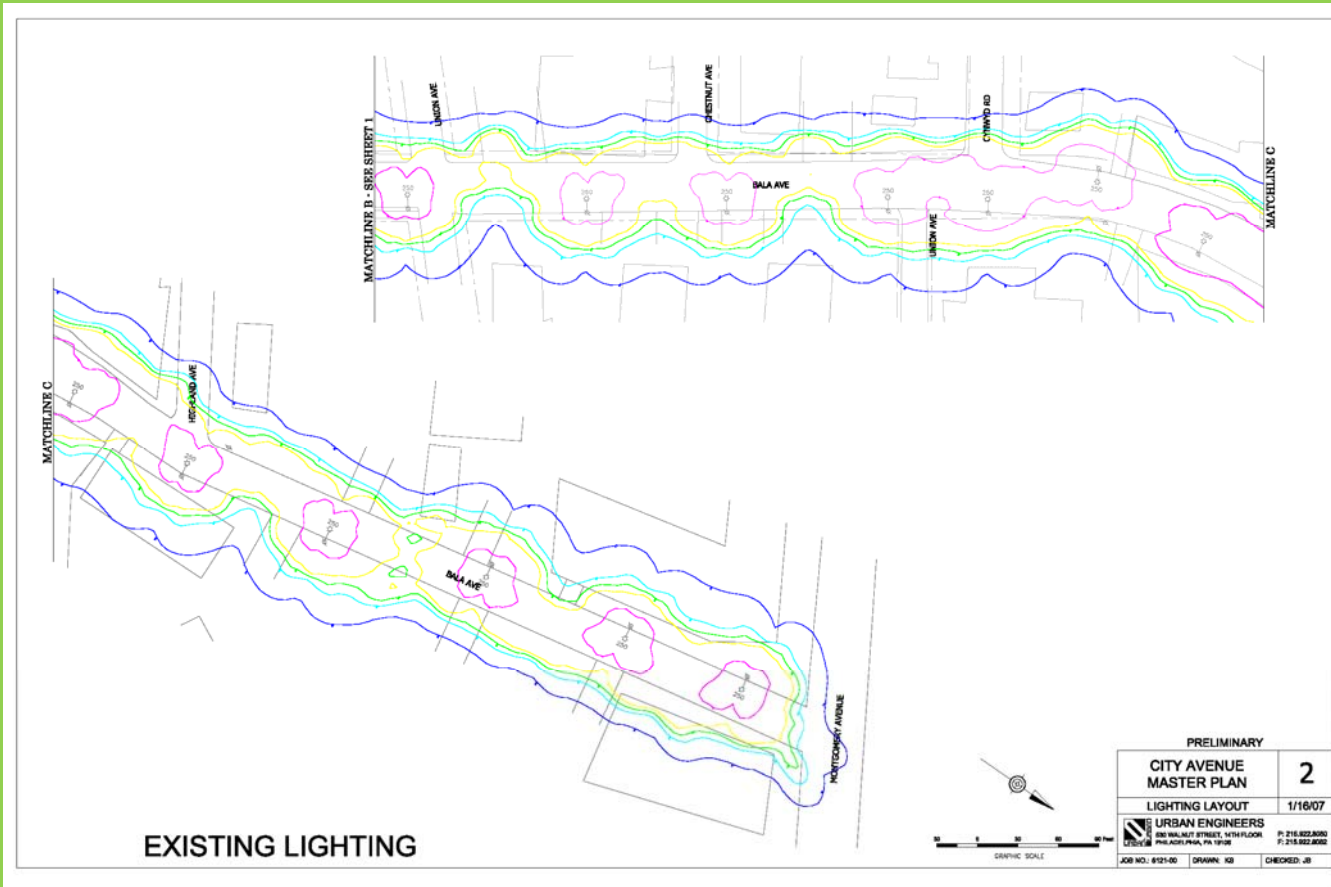

*The Smart Spot*

CityAve

# Schematic Plan – Proposed Layout

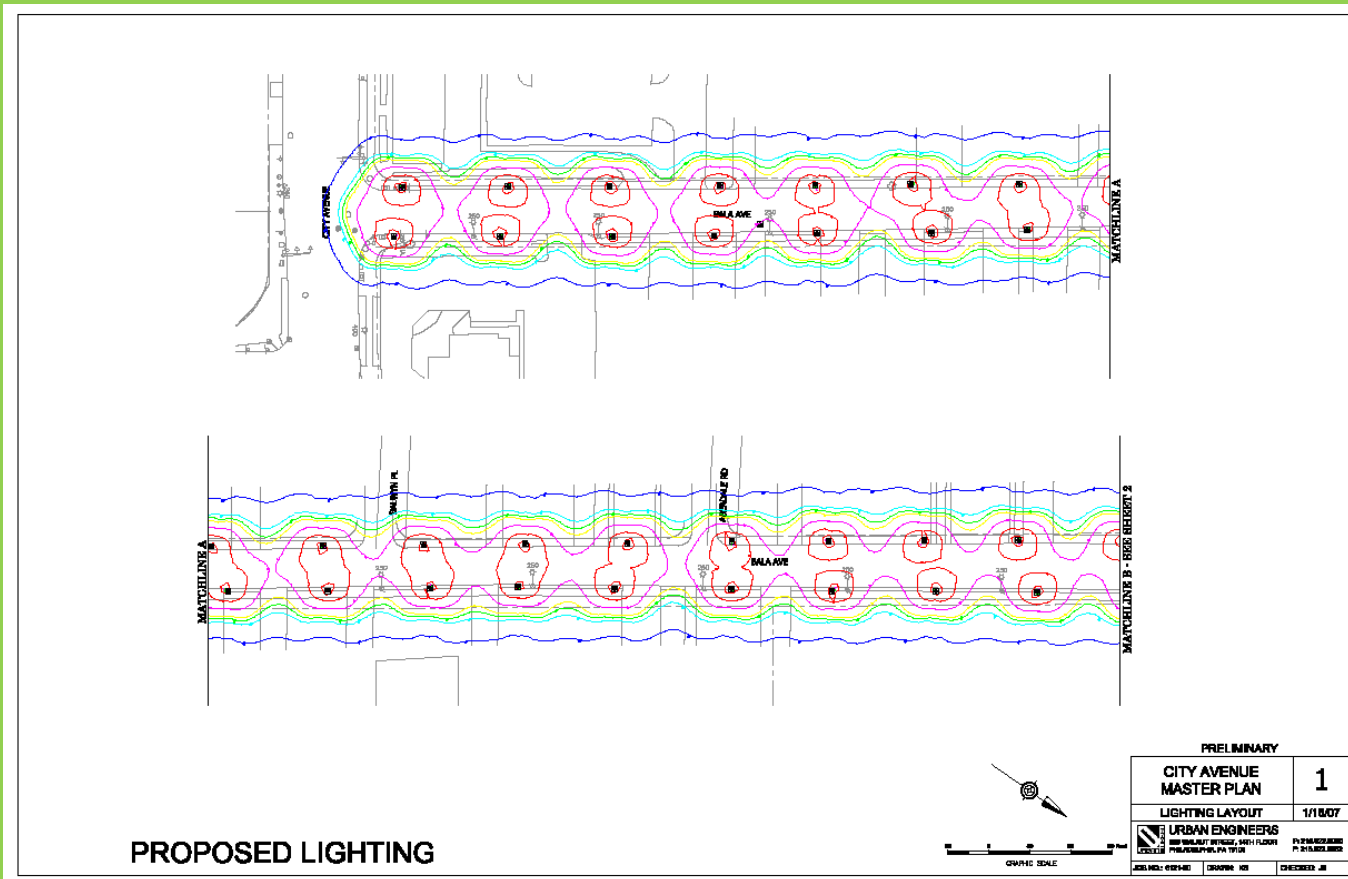

*The Smart Spot*

CityAve

# Schematic Plan - Statistics

City Avenue Master Plan (Preliminary)						
#	Calculation Zone	Existing Lighting		Proposed Lighting		Average Increased Lighting Per Zone %
		Zone Average	Ave/Min	Zone Average	Ave/Min	
1	Presidential Blvd - Monument Rd	2.1	21	3.5	5.8	66.7%
1A	Monument Rd - Decker Blvd	2.3	11.5	2.4	4.0	4.3%
2	Decker Blvd - Kings Grant Dr	1.8	**	2.2	4.4	22.2%
3	Kings Grant Dr - Belmont Ave	1.9	**	2.6	4.3	36.8%
4	Belmont Ave - 47th St	1.9	9.5	2.4	24.0	26.3%
5	47th St - Conshohocken Ave	2.0	20.0	2.4	4.0	20.0%
6	Conshohocken Ave - 50th St	2.2	5.5	2.7	4.5	22.7%
7	50th St - Golf Ave	2.5	5.0	2.5	4.2	0.0%
8	Golf Ave - Bryn Mawr Ave	1.9	9.5	2.5	5.0	31.6%
9	Bryn Mawr Ave - Hampton Ter	2.1	10.5	2.3	3.8	9.5%
10	Hampton Ter - 52nd St	1.7	17.0	2.7	3.9	58.8%
11	52nd St - Oakland Ter	1.9	9.5	2.7	3.0	42.1%
12	Oakland Ter - 54th St	2.2	7.3	2.6	4.3	18.2%
13	54th St - Orchard Rd	1.6	5.3	2.8	4.7	75.0%
14	Orchard Rd - Lapsley Ln	1.4	3.5	2.8	4.7	100.0%
15	Lapsley Ln - Cardinal Ave	1.6	5.3	2.8	4.7	75.0%
16	Cardinal Ave - Berwick Rd	1.3	3.3	2.7	4.5	107.7%
17	Berwick Rd - 59th St	1.6	4.0	2.7	4.5	68.8%
18	59th St - Overbrook Ave	1.6	4.0	2.7	4.5	68.8%
19	Overbrook Ave - Drexel Rd	1.9	4.8	2.6	4.3	36.8%
20	Drexel Rd - 63rd St	1.7	5.7	2.9	4.8	70.6%
21	54th Str Corridor	1.0	7.0	3.0	5.0	200.0%
22	Bala Ave Corridor	1.1	11.0	2.5	6.3	127.3%
Sidewalk 1A	Monument Rd - Belmont Ave	1.5	**	3.3	5.5	120.0%
Sidewalk 1B	Monument Rd - Belmont Ave	1.2	**	3.1	7.8	158.3%
Sidewalk 2A	Belmont Ave - Conshohocken Ave	1.4	14.0	2.8	7.0	100.0%
Sidewalk 2B	Belmont Ave - Conshohocken Ave	1.2	12.0	2.9	29.0	141.7%
Sidewalk 3A	Conshohocken Ave - 54th St	1.3	13.0	3.1	7.8	138.5%
Sidewalk 3B	Conshohocken Ave - 54th St	1.4	7.0	3.1	7.8	121.4%
Sidewalk 4A	54th St - Cardinal Ave	1.0	10.0	3.1	7.8	210.0%
Sidewalk 4B	54th St - Cardinal Ave	1.0	5.0	3.2	6.4	220.0%
Sidewalk 5A	Cardinal Ave - 63rd St	1.1	11.0	3.2	6.4	190.9%
Sidewalk 5B	Cardinal Ave - 63rd St	0.9	9.0	2.9	7.3	222.2%
Sidewalk 6A	54th St (West)	0.9	9.0	3.1	4.4	244.4%
Sidewalk 6B	54th St (East)	0.9	9.0	2.3	4.6	155.6%
Sidewalk 7A	Bala Ave (West)	0.9	3.0	2.5	6.3	177.8%
Sidewalk 8B	Bala Ave (East)	0.9	9.0	2.4	4.8	166.7%
	Entire Corridor	1.9	**	2.6	26.0	36.8%

\*\*Some surface area within the zone is receiving no light. Therefore, the minimum light intensity is zero.

*The Smart Spot*

CityAve





# Engineering & Design

- Urban Engineers
  - \$85,000 cost estimate
  - Community & Economic Development Grants
- Final product is Bid Documents

*The Smart Spot*

CityAve

# Demonstration Project

## ◎ 54<sup>th</sup> Street Corridor

- District paid for Engineering & Design
- Brickstone & St. Joseph's paid for acquisition & Construction

*The Smart Spot*

CityAve

# Demonstration Project

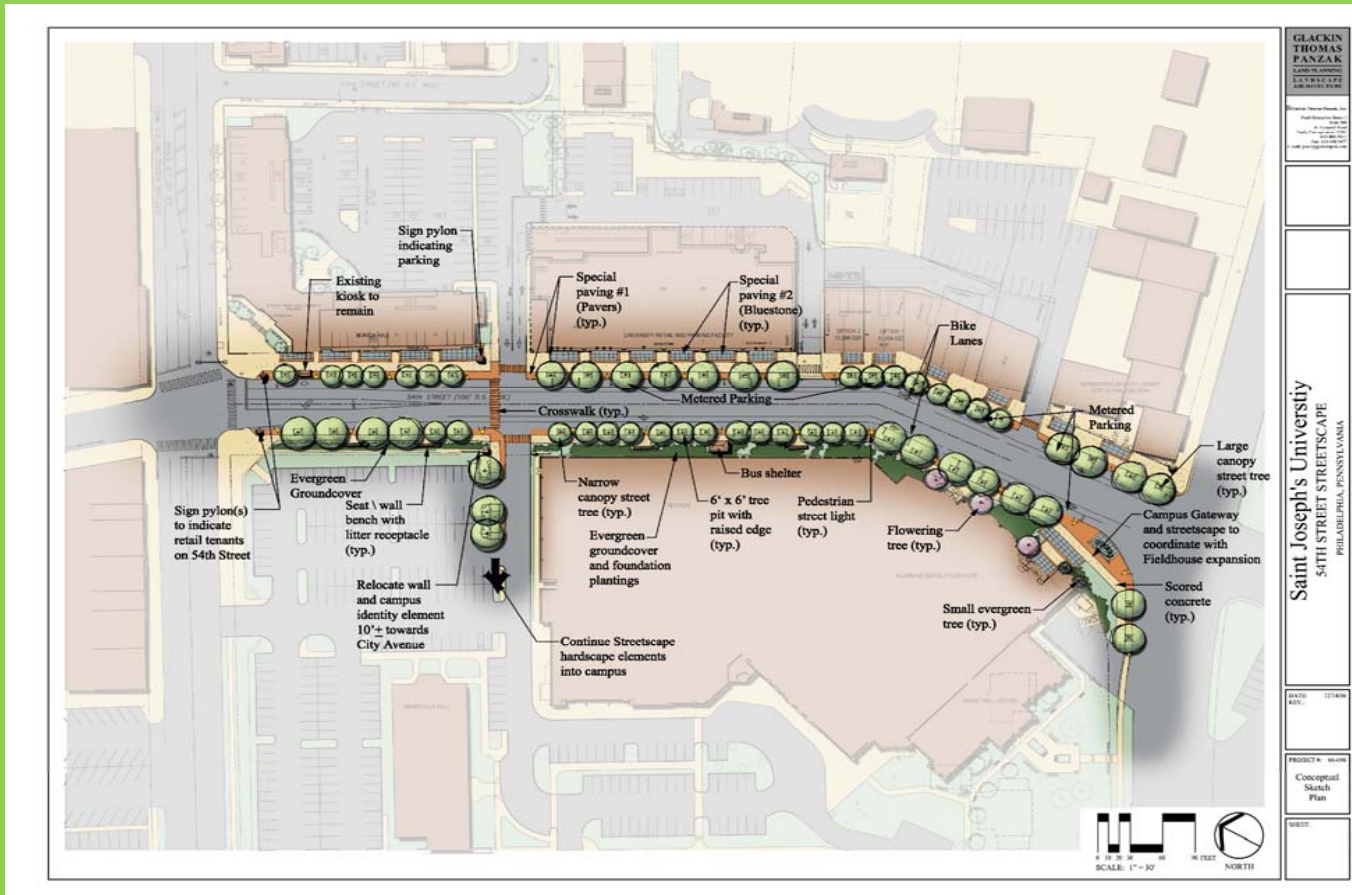

*The Smart Spot*

CityAve

# Funding

## ○ Cost Estimates

- Total Project
  - Sectioned - \$4.6 million
  - Single Project – \$3.8 million
    - \$800,000 savings
- Bala Avenue
  - Entire Corridor - \$720,570
  - Union to Montgomery - \$330, 916

*The Smart Spot*

CityAve

# Funding

## ○ Sources

- State Capital Budget
  - Requires 100% match
    - Federal Earmark
    - County
    - City
    - Township
    - Private
    - District

*The Smart Spot*

CityAve